

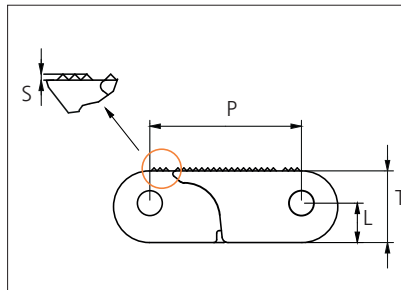

Plastic Modular Belt

Serie **uni AMB** Type **Closed Rough**



Straight running belt
 Nominal pitch: 63.5 mm (2.50 in)
 Surface type: Rough
 Surface opening: Closed
 Backflex radius: 100 mm (3.94 in)
 Pin diameter: 9.0 mm (0.35 in)

STANDARD

Belt material & color	POM NL K		mm	in		mm	in	
Pin and lock material & color	SS N PP O		P (Nominal)	63.5	2.50	T	33.0	1.30
			L	18.2	0.72	S	1.0	0.04

STRAIGHT RUNNING

Belt width		Permissible tensile force (Belt/pin material)		Belt weight (Belt/pin material)		*Min No drive sprocket per haft	Number of wear strips (min no)	
		POM-NL/SS		POM-NL/SS			**Carry (pcs)	**Return (pcs)
mm	in	N	lbf	kg/m	lb/ft			
153	6.0	26540	6191	5.3	3.54	2	2	2
305	12.0	54900	12342	10.5	7.05	3	3	2
458	18.0	82440	18533	15.7	10.58	4	4	2
610	24.0	109800	24683	21.0	14.09	5	5	3
763	30.0	137340	30874	26.2	17.63	6	6	3
915	36.0	164700	37025	31.5	21.14	7	7	4
1068	42.0	192240	43216	36.7	24.68	8	8	4
1220	48.0	219600	49366	41.9	28.19	9	9	5
1373	54.1	247140	55557	47.2	31.72	10	10	5
1525	60.0	274500	61708	52.4	35.24	11	11	6
1678	66.1	302040	67899	57.7	38.77	12	12	6

PITCH 63.5 MM/2.50 IN

Additional standard belt widths are available in steps of 152.5 mm (6.00 in). Additional non-standard belt widths are available in steps of 25.4 mm (1.00 in).

2898	114.1	521640	117265	99.6	66.96	20	20	10
------	-------	--------	--------	------	-------	----	----	----

Additional standard belt widths are available in steps of 152.5 mm (6.00 in). Additional non-standard belt widths are available in steps of 25.4 mm (1.00 in).

4880	192.1	878400	197464	167.8	112.75	33	33	17
------	-------	--------	--------	-------	--------	----	----	----

General belt tolerance is +0/-0.4% at 23°C/73°F and 50% RH. For exact belt width contact Customer Service. Non standard belt width on request.

**Max. Load per Drive Sprocket. Belt material: Pom NL 15000 N (3372 lbf)

***Max. Spacing between wear strips, Carry: 152 mm (6 in); Return: 304 mm (12 in).

= Single Link



Accessories

Top/Bottom Insert



+



=



Photo shows bottom of the belt

Type	Insert material & color	Weight	
		kg/m ²	lb/ft ²
Wheel Plate	POM DK O	4.7	0.97

Top/Bottom Insert

EC insert in uni AMB 4% Rough type can be build in to uni AMB C Rough to create an electrical conductive belt.



+



=



EC Grip surface located above the belt surface to ensure 'electro static discharge'

Type	Insert material & color	Weight	
		kg/m ²	lb/ft ²
Electrical Conductive	POM EC K	5.2	1.07

POM EC holds a surface resistivity of 1×10^3 Ohm according to IEC 60093/ASTM D257.

Flight

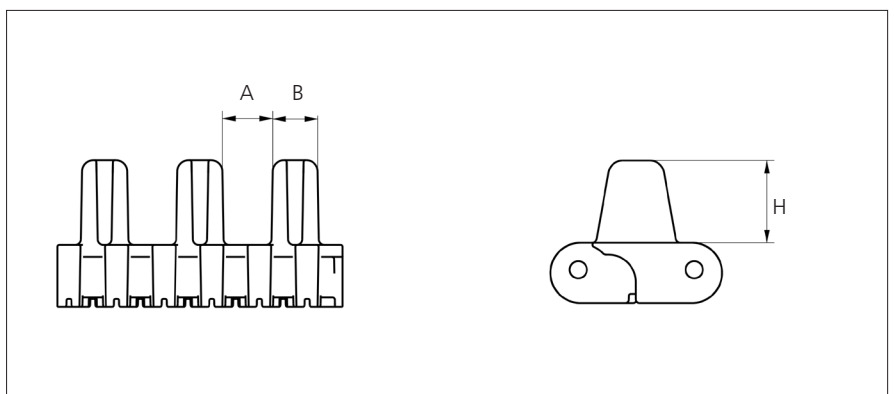

Type	Flight material & color	A		B		H		Link size	Width	
		mm	in	mm	in	mm	in		mm	in
Car Pusher	POM NL O	25.5	1.00	25.3	0.99	45.0	1.77	K600	152.4	6.00

Backflex radius when flights are used: 120 mm (4.72 in).

Sprocket

No. of teeth	Bore size						Overall diameter		Pitch diameter		Hub diameter		Dimension A*		Dimension B		Double row/One way	Machined 
	Pilot Bore	in	2.36	2.5	3.54	4.72												
	mm	60.0	63.5	90.0	120.0	mm	in	mm	in	mm	in	mm	in					
Z10	✓	■	■	■			211.2	8.31	205.9	8.09	149.0	5.87	79.5	3.13	117.2	4.61	✓	✓
Z13	✓	■	■	■	■		273.4	10.76	265.3	10.45	211.0	8.31	110.6	4.35	147.2	5.80	✓	✓
Z15	✓	■	■	■	■		314.5	12.38	305.4	12.02	252.0	9.92	131.1	5.16	167.3	6.59	✓	✓
Z20	✓	■	■	■	■		416.7	16.41	405.9	15.98	355.0	13.97	182.2	7.17	217.6	8.57	✓	✓

*A-dimension for automotive applications use A = (B-29.8 mm/1.17 in).

Non standard material and color: See uni Material and Color Overview.

■ Machined sprocket

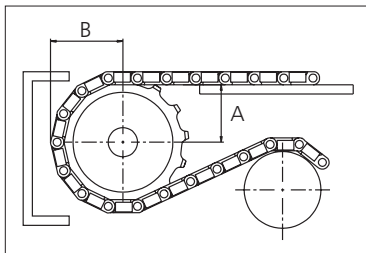

Other sprocket sizes are available upon request.

Two-part sprocket are available upon request.

Other bore sizes are available upon request.

uni Retainer Rings: See uni Retainer Ring data sheet

Width of single tooth = 9.0 mm (0.35 in)

Width of sprocket = 50 mm (1.97 in)

Max load per sprocket shown does not take bore size into account.

Please also ensure that sufficient size shaft is chosen for corresponding load.

For correct sprocket position: See uni Assembly Instructions for uni AMB.

For more detailed sprocket information, contact Customer Service.

uni AMB/2020.11.02

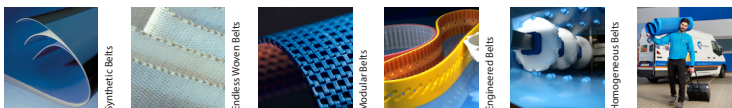

Expert advice and quality solutions for all your belting needs.
ammeraalbeltech.com

Ammeraal Beltech Modular A/S
 Hjulmagervej 21
 DK-7100 Vejle

T +45 7572 3100

This information is subject to alteration due to continuous development. Ammeraal Beltech will not be held liable for the incorrect use of the above stated information. This information replaces previous information. All activities performed and services rendered by Ammeraal Beltech are subject to general terms and conditions of sale and delivery, as applied by its operating companies.

amma.com

Member of Ammega Group.