

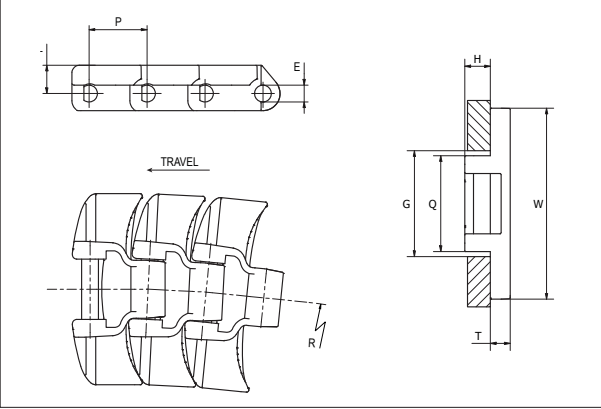

# Slat Top Plastic Chain

Series **uni 253 FT** Type **Magnetic**

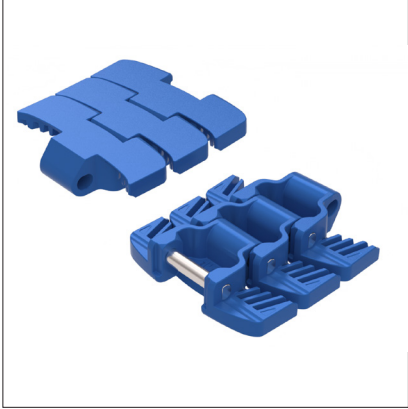

**Slat Top Plastic Chain**  
 Side flexing chain  
 Pitch: 25.4 mm (1.00 in)  
 Backflex radius:  
 200 mm (7.87 in)  
 Permissible tensile strength:  
 All POM materials: 1500 N  
 (337 lbf)  
 Standard shipping lengths:  
 boxes of 120 links  
 = 3.048 m (10.0 ft)

STANDARD

| E   |      | G    |      | H    |      | L    |      | P    |      | Q    |      | T   |      |
|-----|------|------|------|------|------|------|------|------|------|------|------|-----|------|
| mm  | in   | mm   | in   | mm   | in   | mm   | in   | mm   | in   | mm   | in   | mm  | in   |
| 7.1 | 0.28 | 44.0 | 1.73 | 11.3 | 0.44 | 12.4 | 0.49 | 25.4 | 1.00 | 42.0 | 1.65 | 8.7 | 0.34 |

All dimensions are for chains in POM material.

|             | Width (W) |      | Material & color   | Pin material | Weight |       | Min. radius (R) |       |
|-------------|-----------|------|--|--------------|--------|-------|-----------------|-------|
|             | mm        | in   |  |              | kg/m   | lb/ft | mm              | in    |
| <b>K330</b> | 83.8      | 3.30 | POM-D <b>B</b><br>POM-DK <b>DG</b><br>PA6.6-GFH <b>K</b> | <b>SS431</b> | 1.42   | 0.95  | 500             | 19.69 |
| <b>K450</b> | 114.3     | 4.50 | POM-D <b>B</b>   | <b>SS431</b> | 1.67   | 1.12  | 500             | 19.69 |
| <b>K750</b> | 190.5     | 7.50 | POM-D <b>B</b>   | <b>SS431</b> | 2.27   | 1.53  | 610             | 24.02 |

Non standard material and color: See uni Material and Color Overview.  
 Non standard pin material: See uni Material and Color Overview.

SIDE FLEXING

PITCH 25.4 MM/1.00 IN

## Sprocket

| No. of teeth | Metric bore |            |      |      |      |      | Imperial bore |       | Overall diameter |       | Pitch diameter |       | Hub diameter |       | Dimension A |       | Dimension B |  | Machined solid sprocket PA6 | Machined solid idler PA6 |
|--------------|-------------|------------|------|------|------|------|---------------|-------|------------------|-------|----------------|-------|--------------|-------|-------------|-------|-------------|--|-----------------------------|--------------------------|
|              | in          | 0.32       | 0.98 | 1.18 | 1.57 | 1.00 | 1.50          |       |                  |       |                |       |              |       |             |       |             |  |                             |                          |
|              | mm          | Pilot-Bore | 25.0 | 30.0 | 40.0 | 25.4 | 38.1          | mm    | in               | mm    | in             | mm    | in           | mm    | in          |       |             |  |                             |                          |
| Z16          |             |            |      |      |      |      |               | 132.1 | 5.20             | 130.2 | 5.13           | 110.0 | 4.33         | 67.5  | 2.66        | 78.3  | 3.08        |  |                             |                          |
| Z18          |             |            |      |      |      |      |               | 148.5 | 5.85             | 146.3 | 5.76           | 126.0 | 4.96         | 75.7  | 2.98        | 86.2  | 3.39        |  |                             |                          |
| Z21          |             |            |      |      |      |      |               | 179.9 | 7.08             | 170.4 | 6.71           | 150.0 | 5.91         | 88.0  | 3.46        | 98.3  | 3.87        |  |                             |                          |
| Z31          |             |            |      |      |      |      |               | 254.2 | 10.01            | 251.1 | 9.89           | 230.0 | 9.06         | 128.6 | 5.06        | 138.4 | 5.45        |  |                             |                          |

Machined solid sprocket Machined square bore

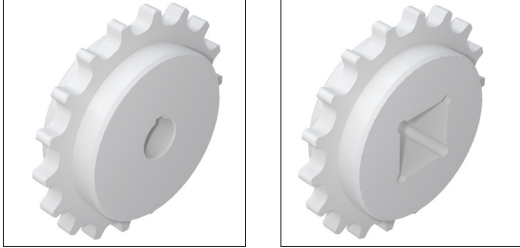

Non standard material and color:  
See uni Material and Color Overview.  
Width of tooth: 11.0 mm (0.43 in)  
Width of sprocket: 30.0 mm (1.18 in)

## Two-part sprocket

| No. of teeth | Metric bore |            |      |      | Overall diameter |       | Pitch diameter |      | Hub diameter |      | Dimension A |      | Dimension B |      | Machined split sprocket PA6 | Machined split idler PA6 |
|--------------|-------------|------------|------|------|------------------|-------|----------------|------|--------------|------|-------------|------|-------------|------|-----------------------------|--------------------------|
|              | in          | 0.32       | 0.98 | 1.57 |                  |       |                |      |              |      |             |      |             |      |                             |                          |
|              | mm          | Pilot-Bore | 25.0 | 40.0 | mm               | in    | mm             | in   | mm           | in   | mm          | in   |             |      |                             |                          |
| Z16          |             |            |      |      | 132.1            | 5.20  | 130.2          | 5.13 | 110.0        | 4.33 | 67.5        | 2.66 | 78.3        | 3.08 |                             |                          |
| Z18          |             |            |      |      | 148.5            | 5.85  | 146.3          | 5.76 | 126.0        | 4.96 | 75.7        | 2.98 | 86.2        | 3.39 |                             |                          |
| Z21          |             |            |      |      | 179.9            | 7.08  | 170.4          | 6.71 | 150.0        | 5.91 | 88.0        | 3.46 | 98.3        | 3.87 |                             |                          |
| Z31          |             |            |      |      | 254.2            | 10.01 | 251.1          | 9.89 | 230.0        | 9.06 | 128.6       | 5.06 | 138.4       | 5.45 |                             |                          |

Machined two-part sprocket

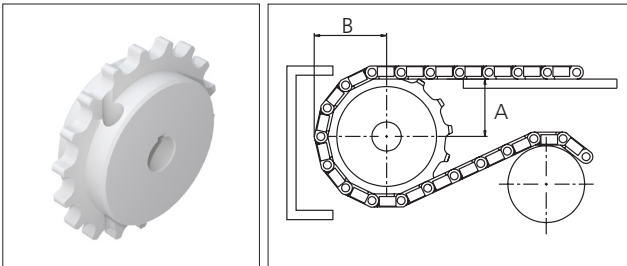

Please ensure that sufficient size shaft and keyway are chosen for corresponding load.

Non standard material and color:  
See uni Material and Color Overview.

Other sprocket sizes are available upon request  
Width of tooth: 11.0 mm (0.43 in)  
Width of sprocket: 30.0 mm (1.18)  
uni Retainer Rings: See uni Retainer Ring data sheet  
uni Idler: See uni Idler data sheet

uni 253 FT Magnetic/2024.06.27



The local partner of choice for sustainable conveyor belting solutions – around the globe.  
<http://eptool.online>

Member of Ammega Group.



Scan the QR code and find your local contact

**Ammeraal Beltech Modular**  
Hjulmagervej 21  
DK-7100 Vejle  
T +45 7572 3100

<http://eptool.online>